

**MANUAL DE MONTAJE**

# **SNK50**

# **KIT acústica**

**aislamiento termo-acústico**

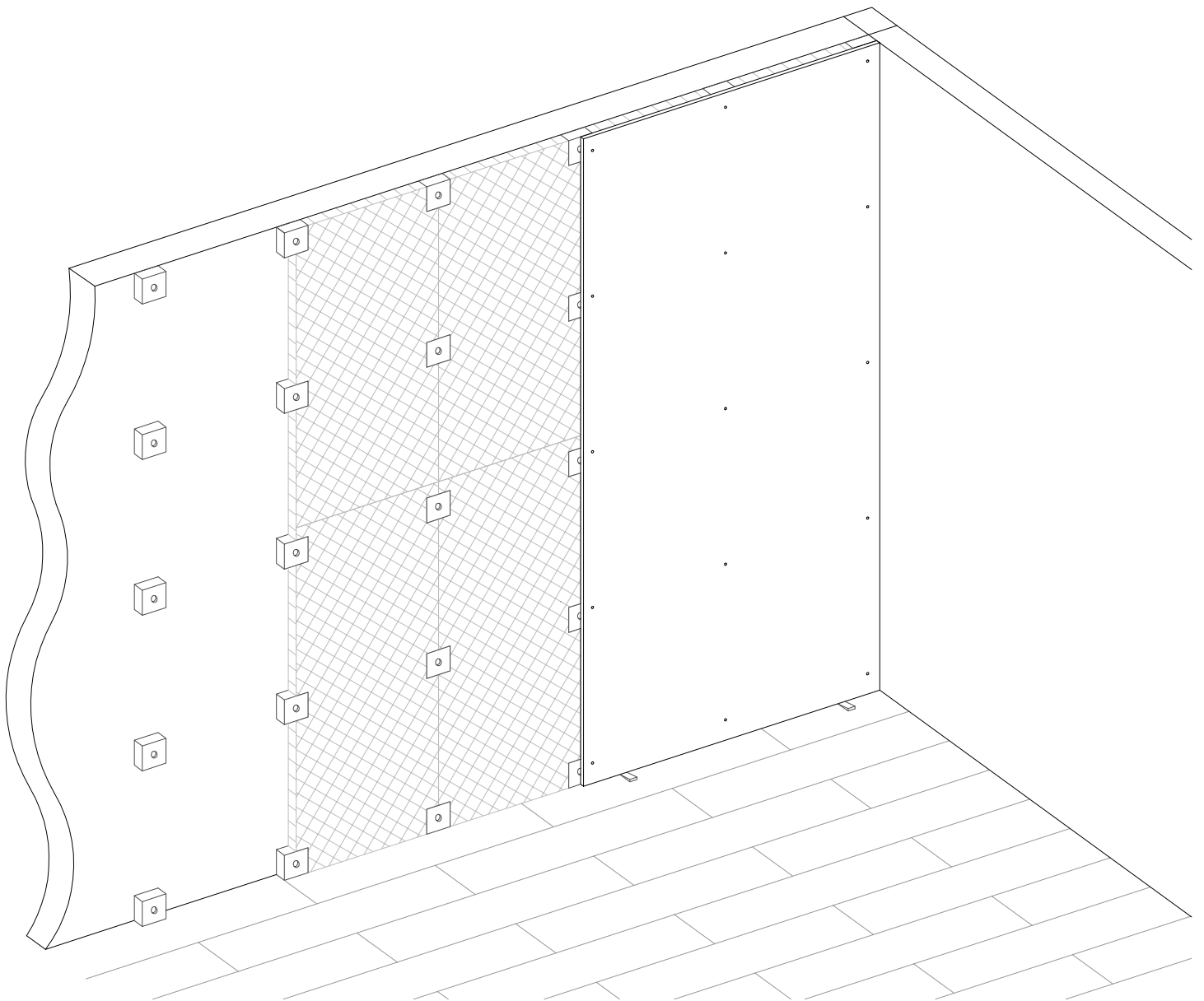

# SNK50 - KIT acústica

## HERRAMIENTAS

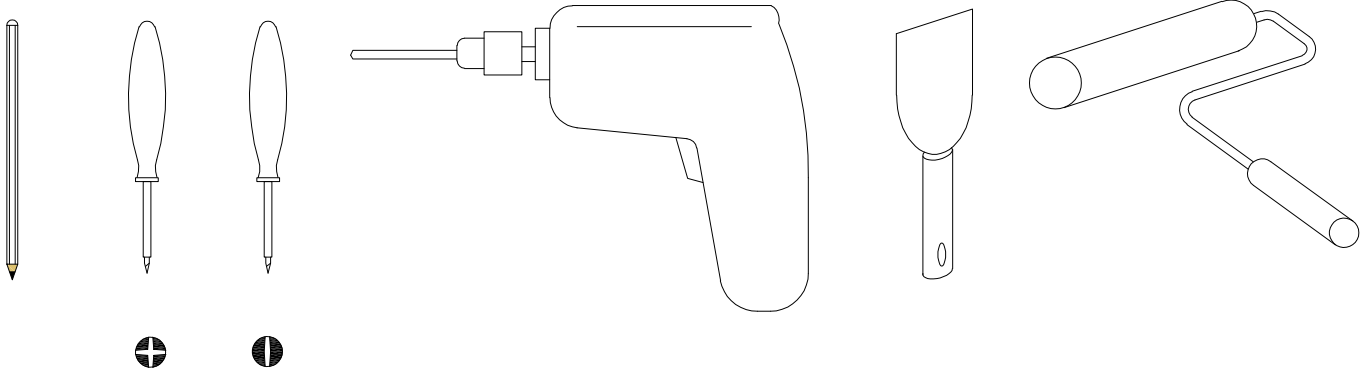

## MATERIAL KIT acústica

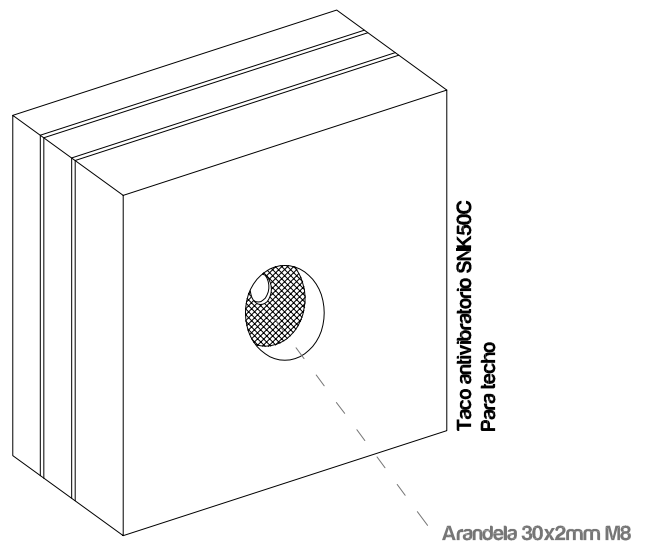
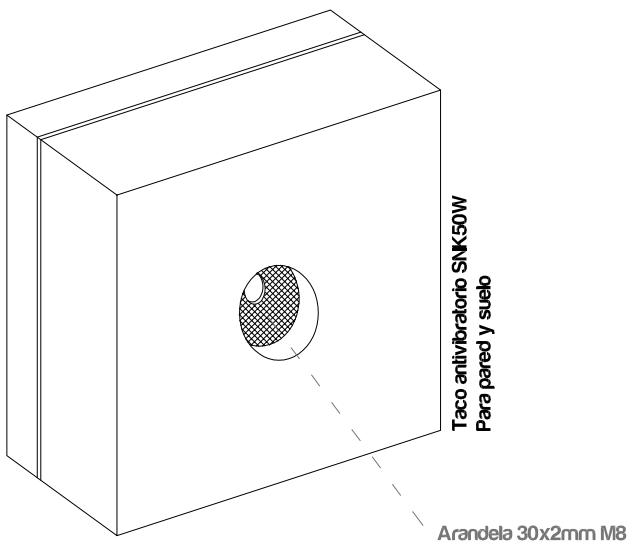

## MATERIAL ADICIONAL AL KIT

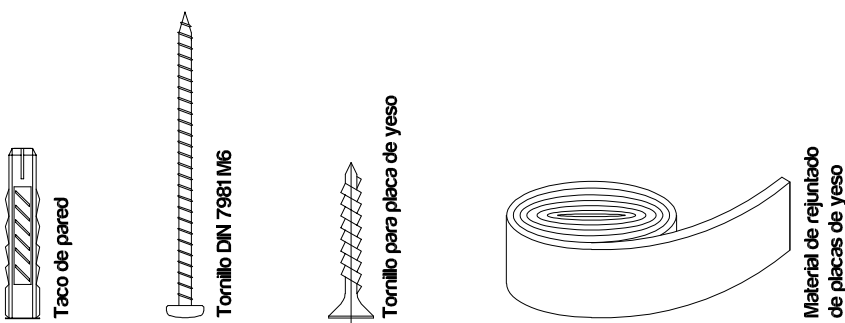

- + Aislamiento termo-acústico
- + Placas de yeso laminado o de madera MDF
- + Cintas y pastas de acabado
- + Material para el acabado final

# SNK50 - KIT acústica

1

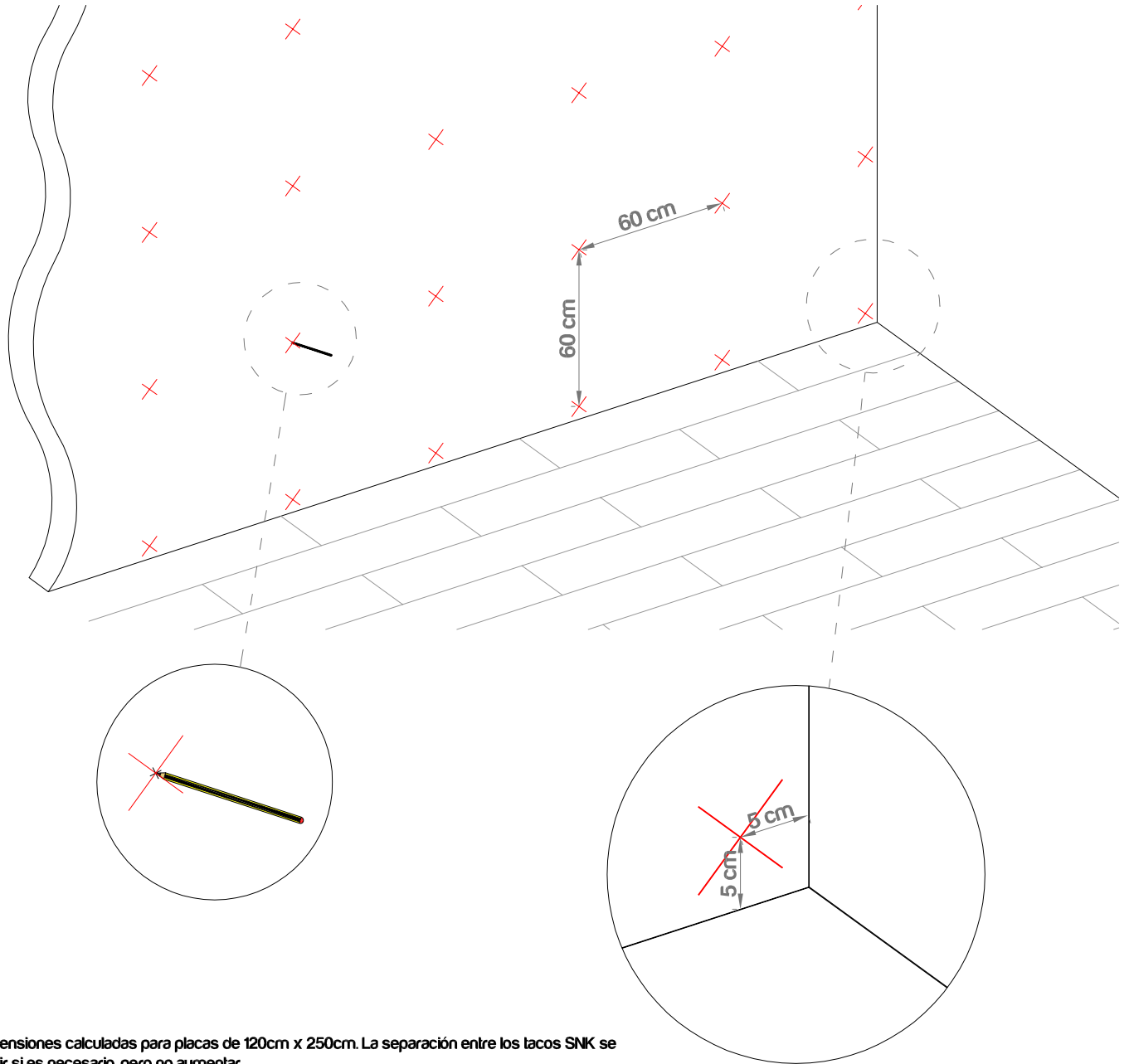

**Nota 1:** Dimensiones calculadas para placas de 120cm x 250cm. La separación entre los tacos SNK se puede reducir si es necesario, pero no aumentar.

**Nota 2:** Si solo se instala el kit en una pared la primera columna debe estar separada 55cm en lugar de 60cm

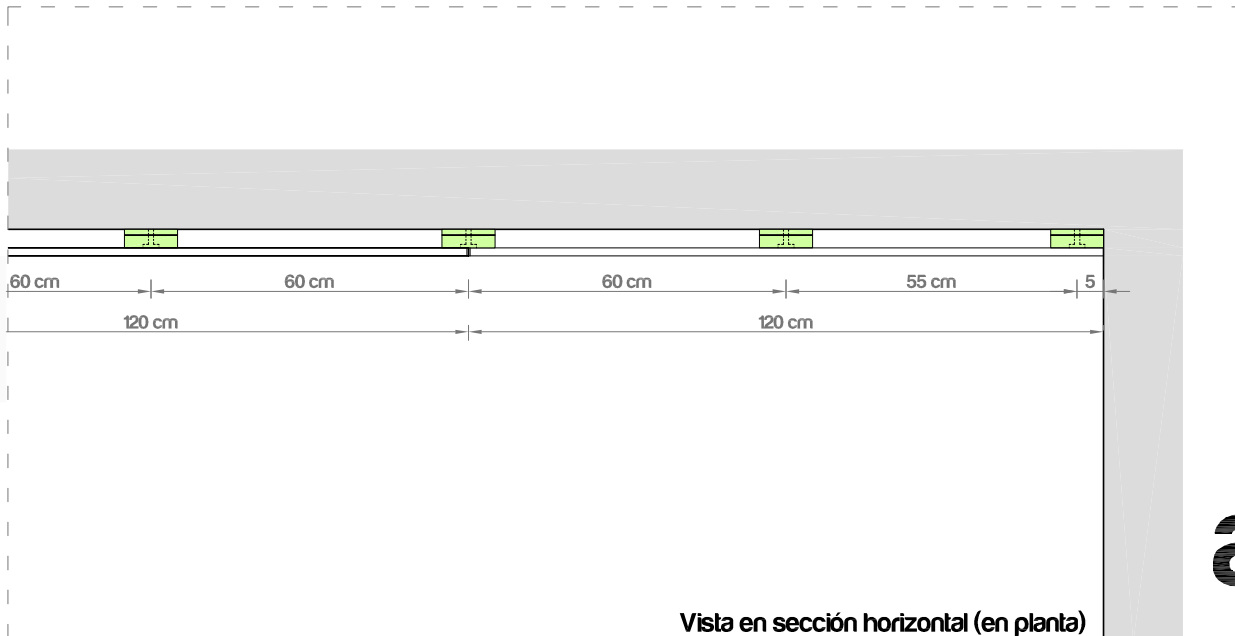

Vista en sección horizontal (en planta)

# SNK50 - KIT acústica

2

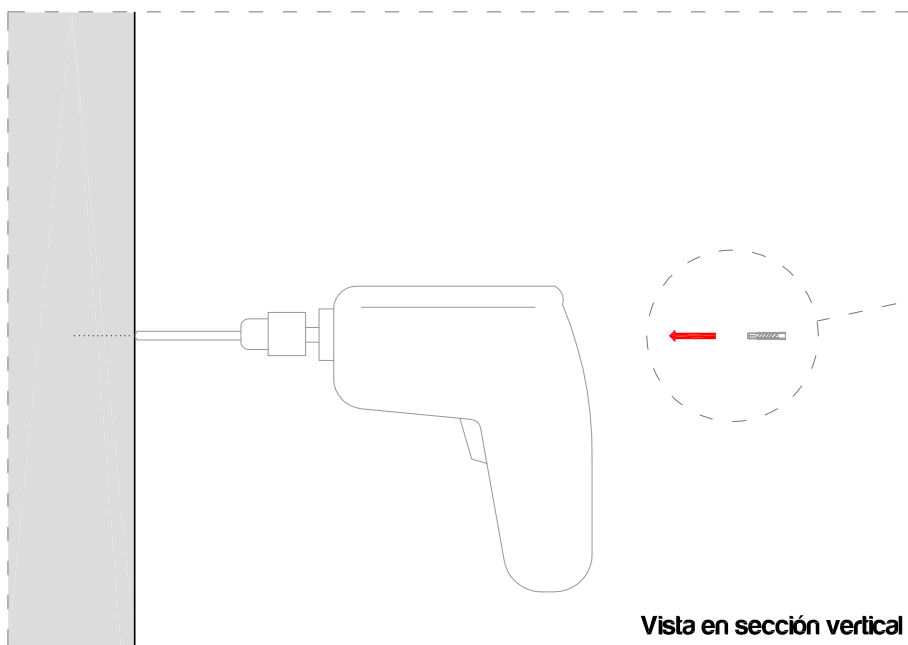
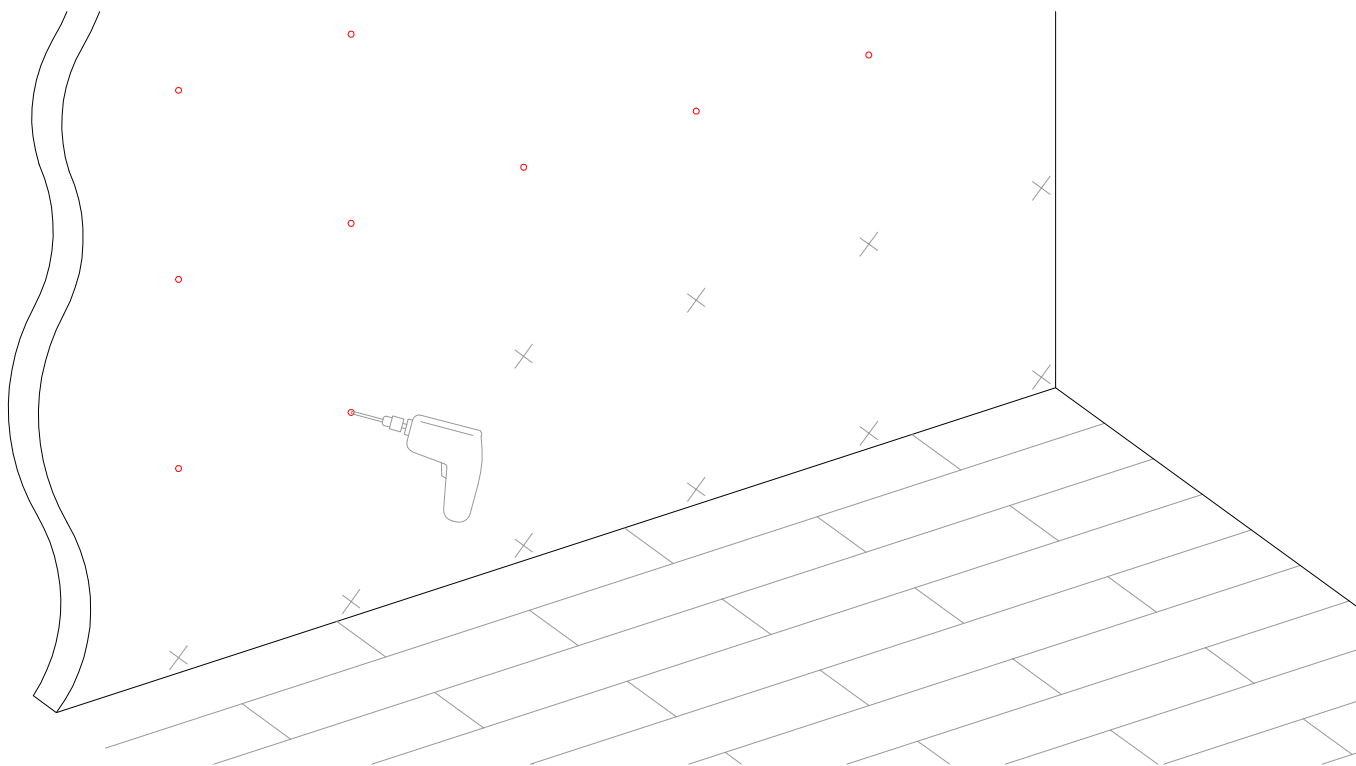

Taco de pared

Vista en sección vertical

# SNK50 - KIT acústica

3

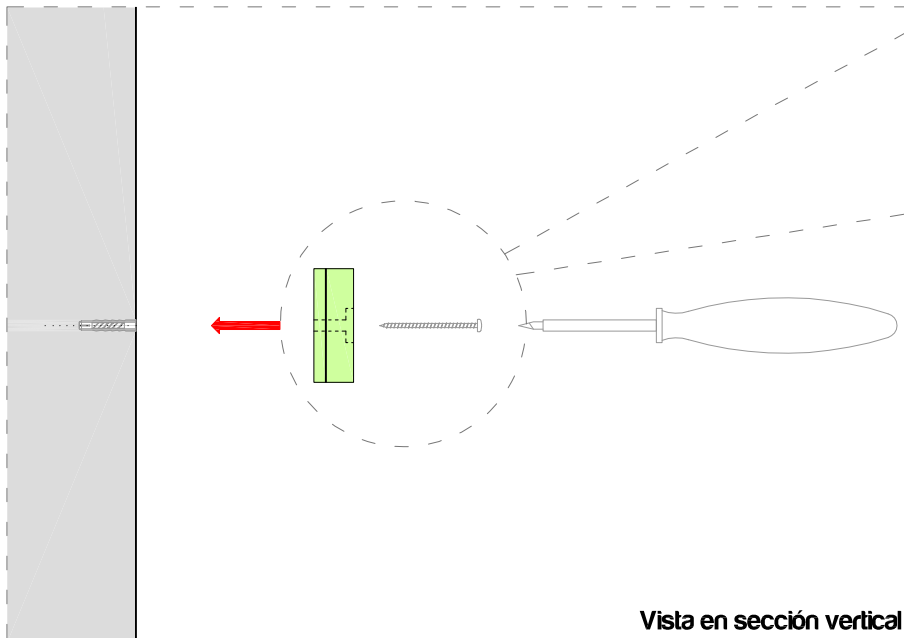
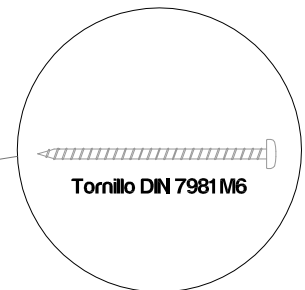
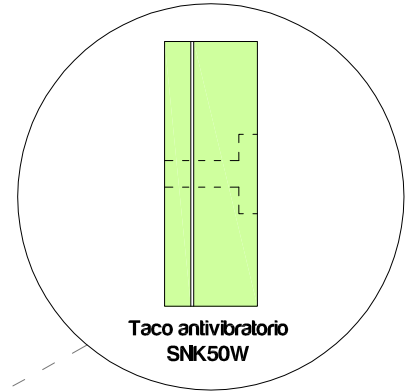
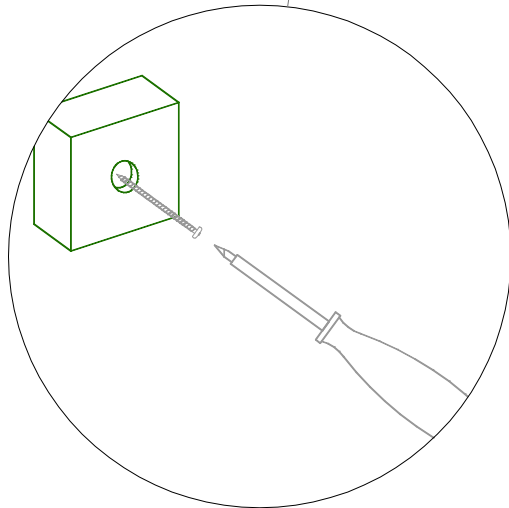
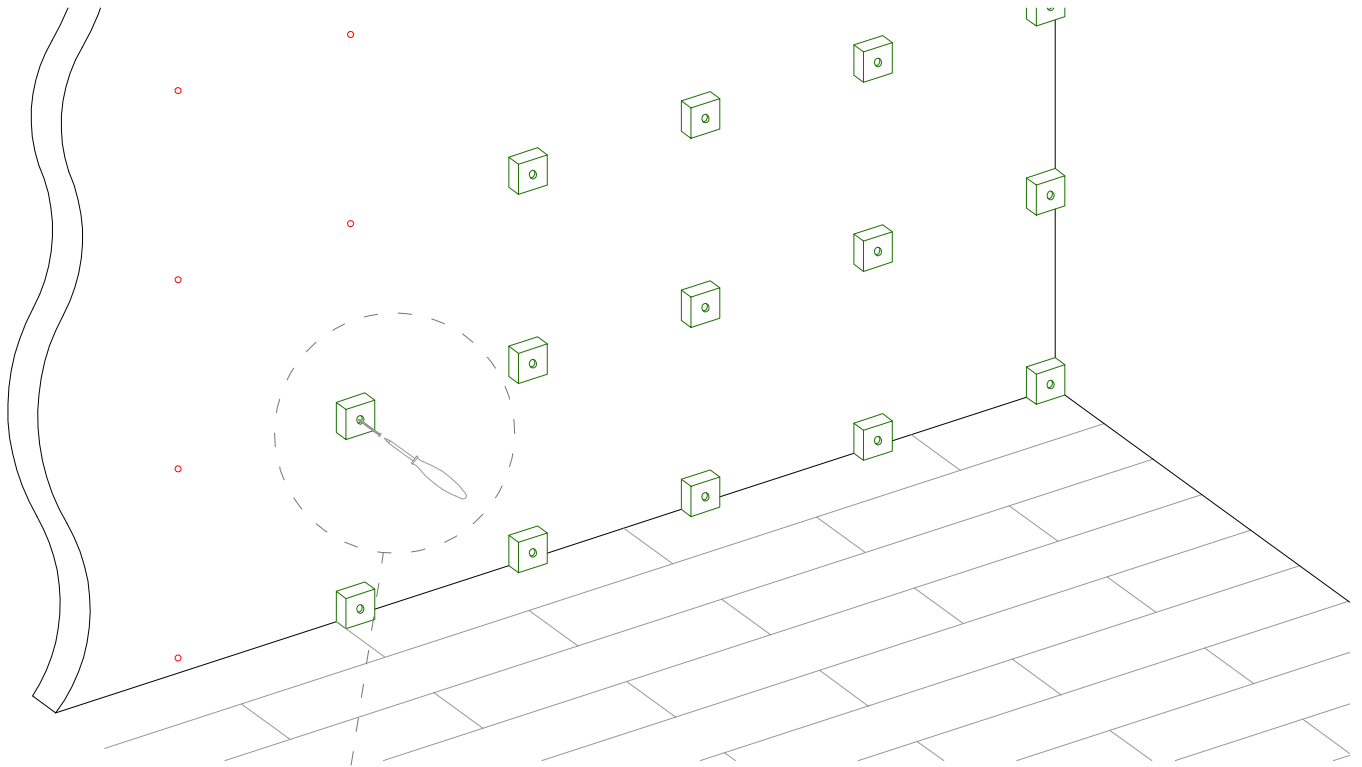

Vista en sección vertical

# SNK50 - KIT acústica

4

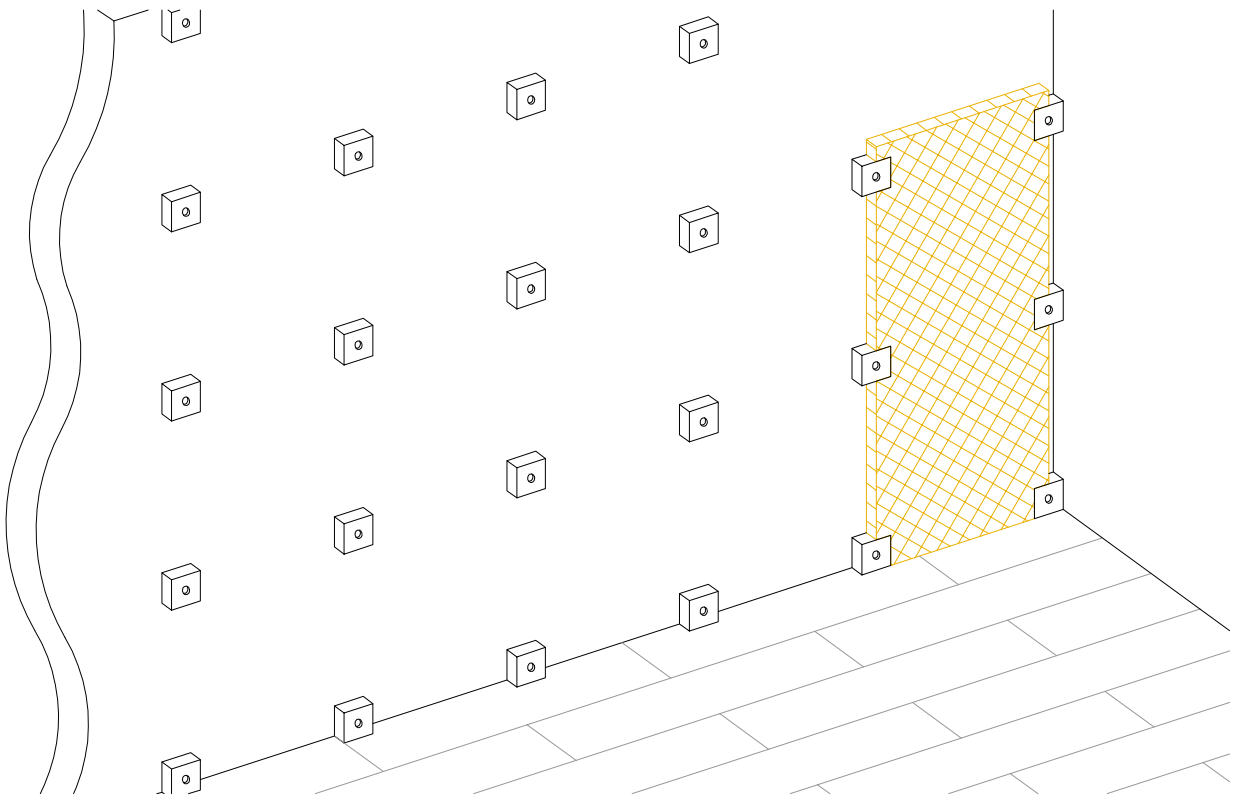

Deberemos adaptar la fibra encajandola entre los soportes antivibratorios SNK50W

Debemos cubrir la totalidad de la superficie con el material de aislamiento.

Si al colocar el aislamiento este no se sujeta podemos ayudarnos mediante cola o cinta adhesiva.

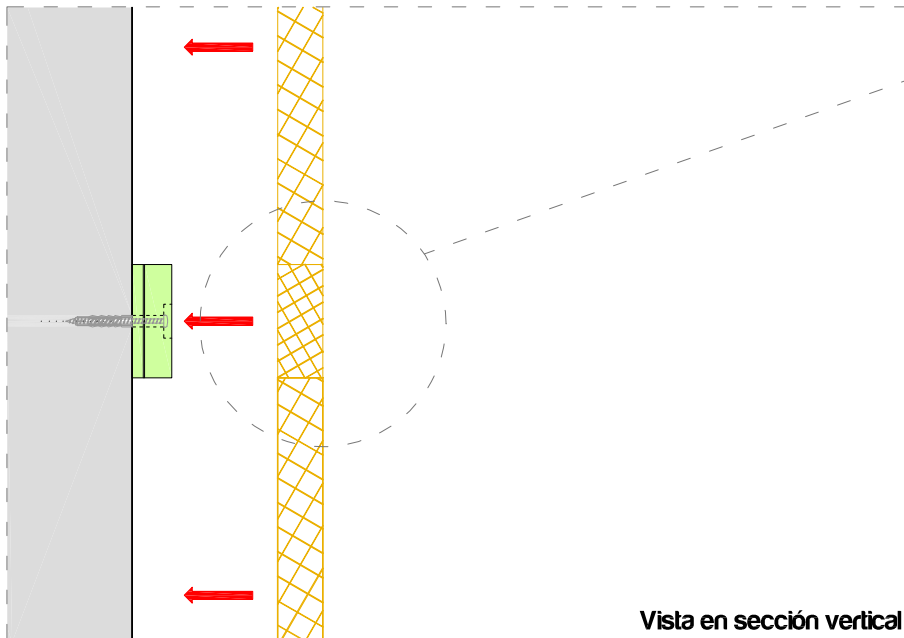

Vista en sección vertical

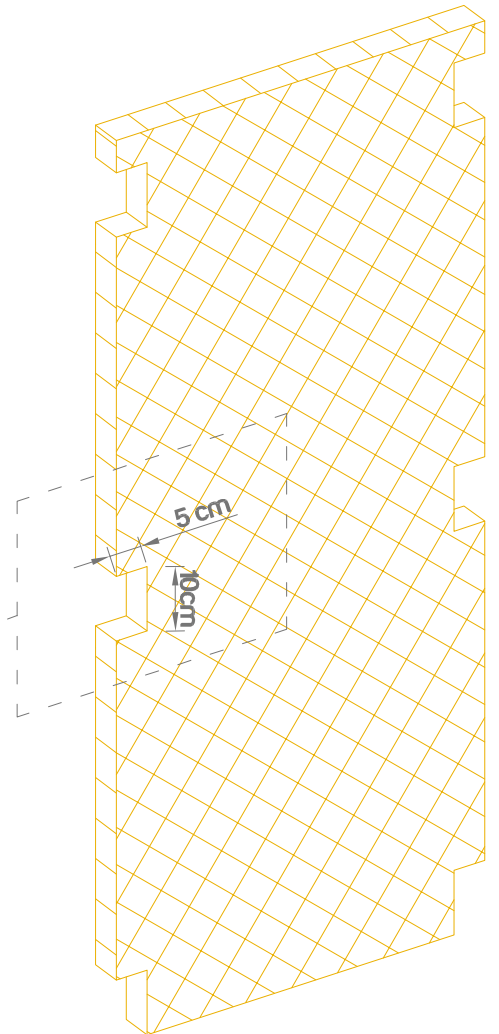

# SNK50 - KIT acústica

4

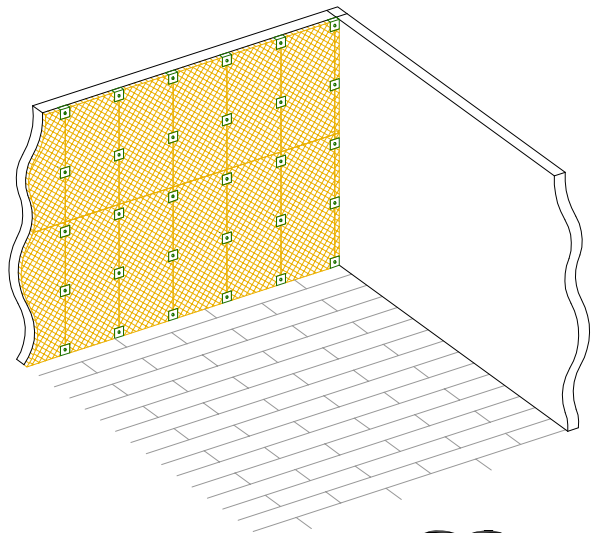
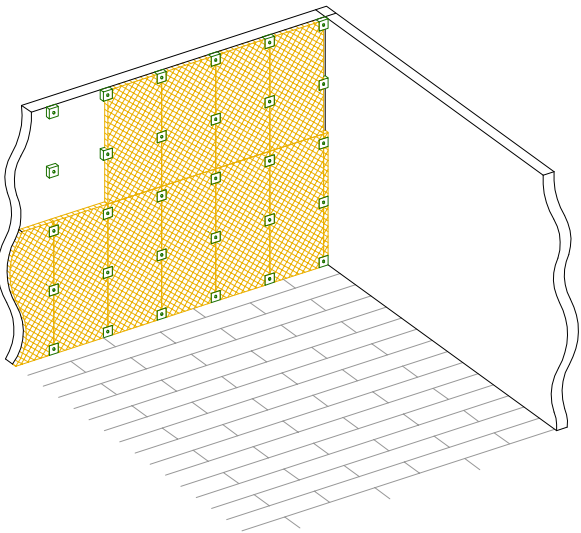
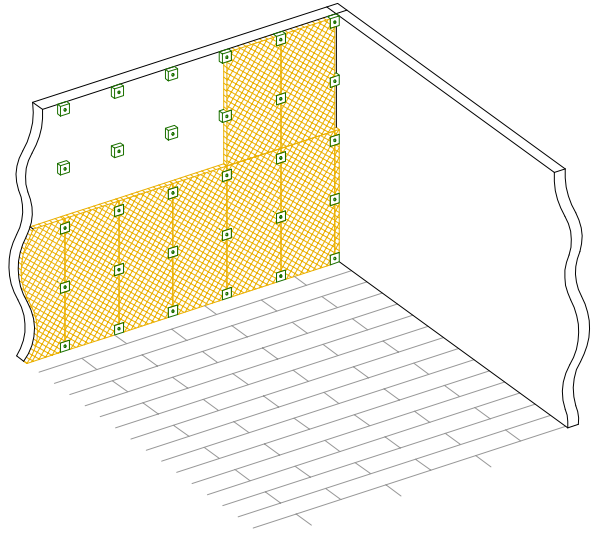
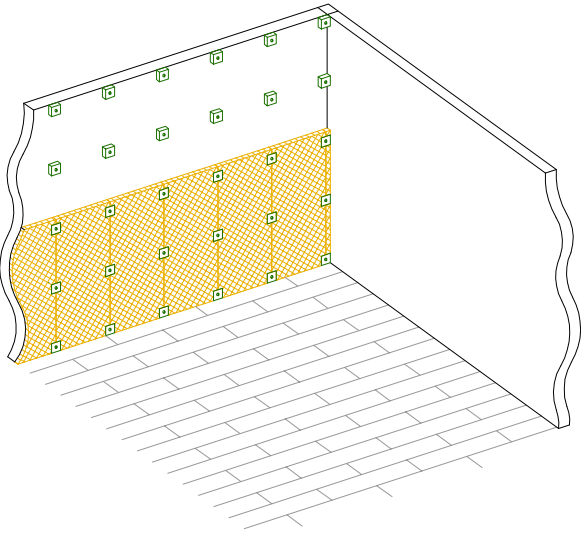
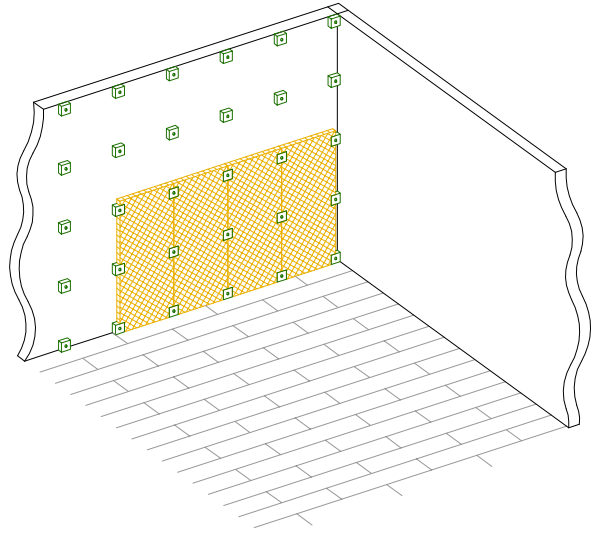
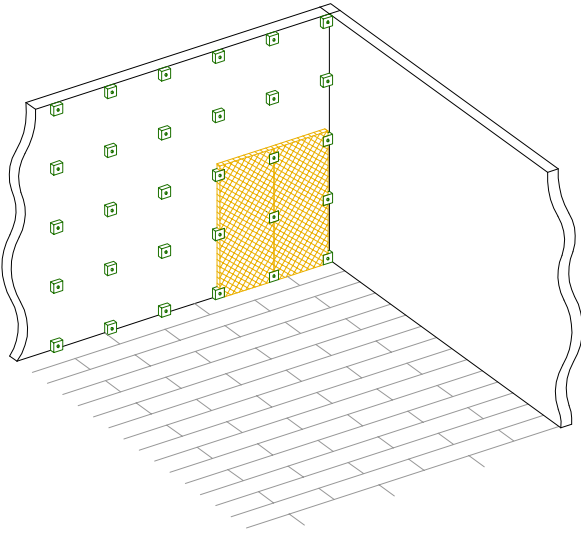

# SNK50 - KIT acústica

## 5

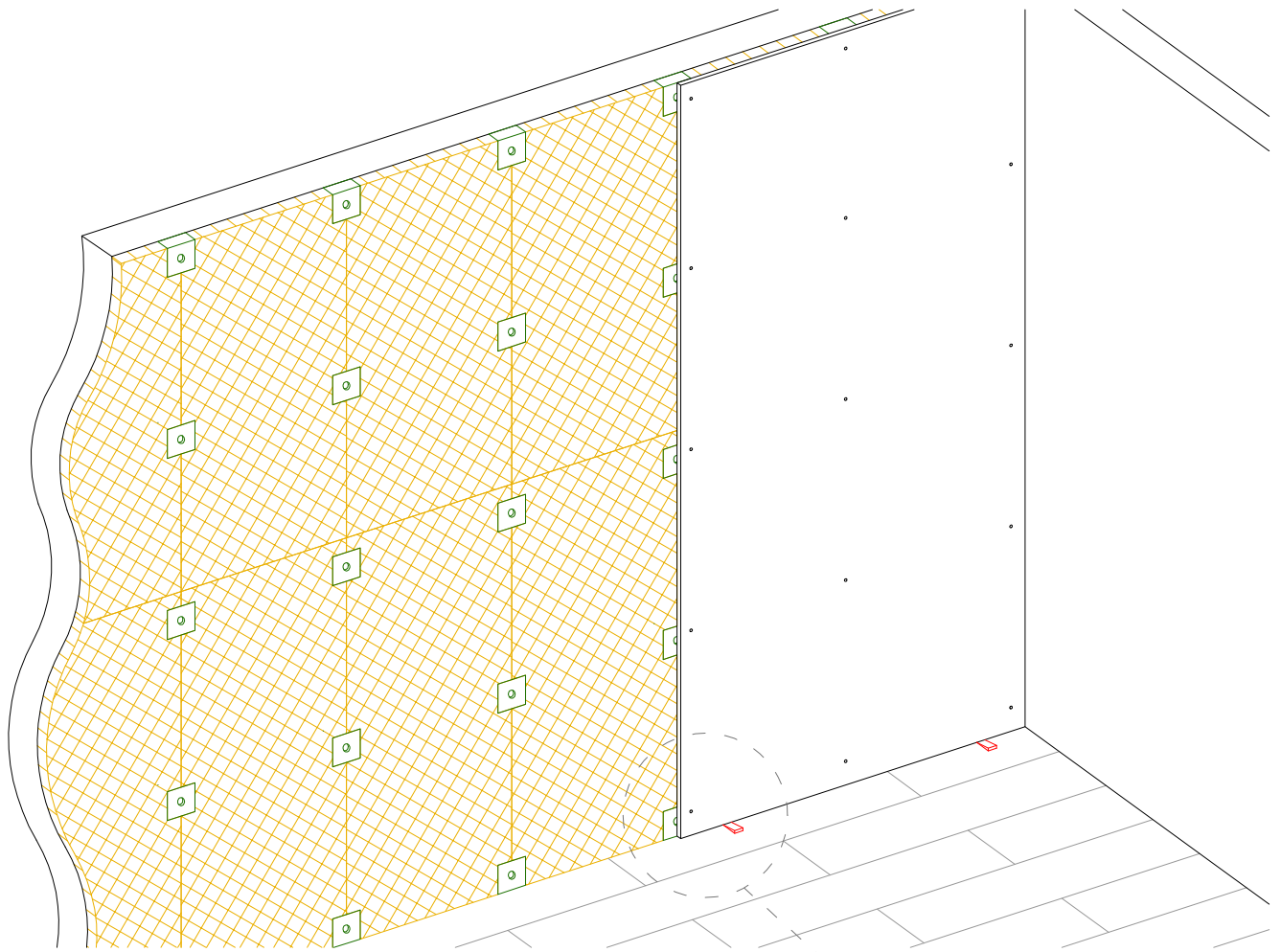

1. Colocamos las placas de yeso laminado o MDF.
2. Colocamos cuñas que nos eleven las placas del suelo.
3. Atornillamos las placas a los tacos antivibratorios con tornillos para placas de yeso laminado.

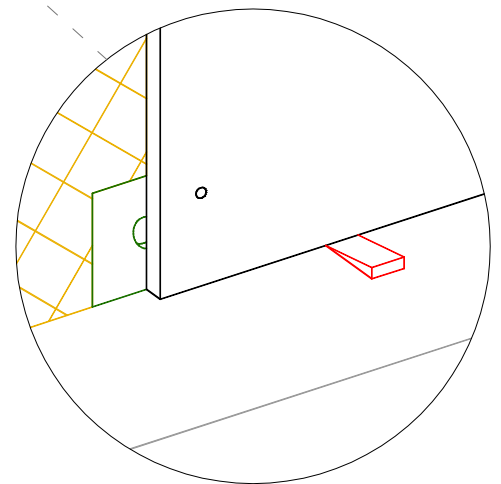

**ATENCIÓN!** Mediante unas cuñas nos aseguraremos que las placas no toquen el pavimento, paredes o techo.

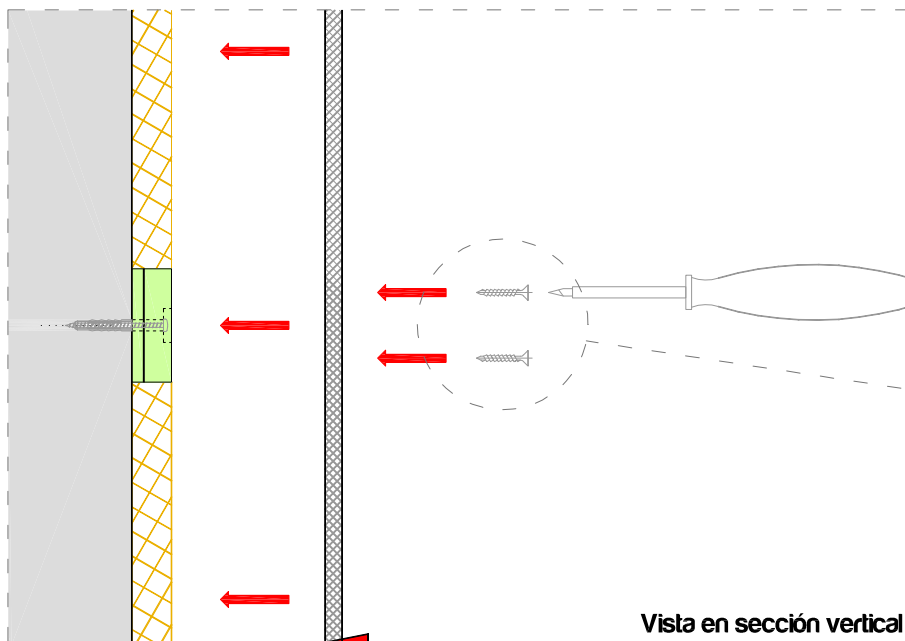

Vista en sección vertical

Tornillo para  
placa de yeso



5

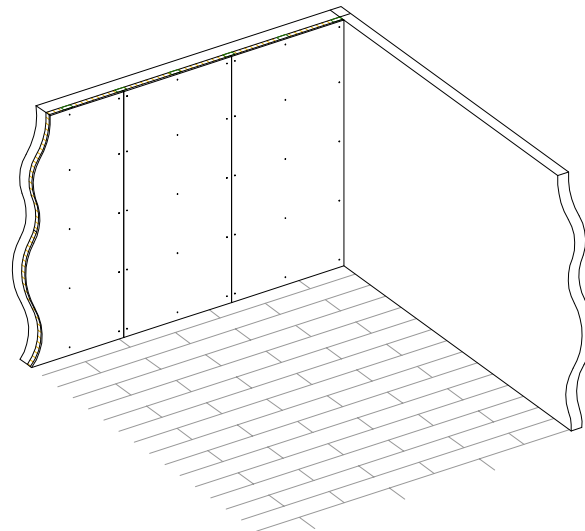
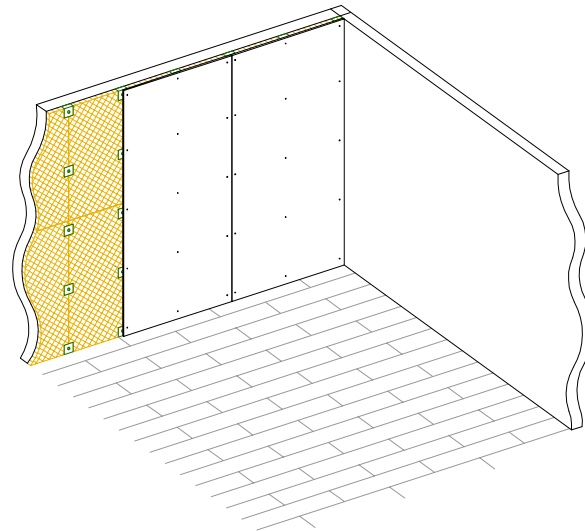
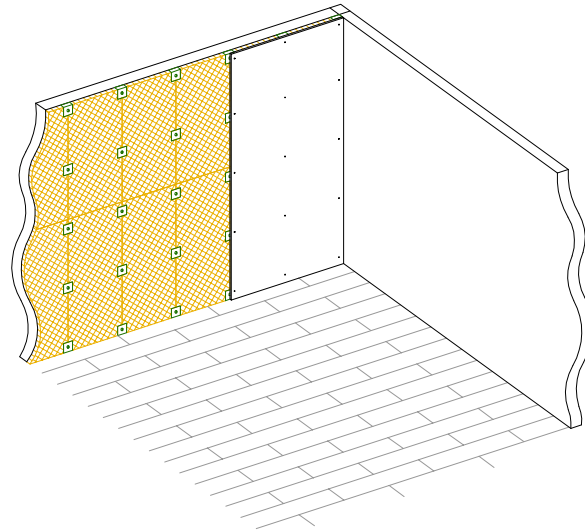



# SNK50 - KIT acústica

7

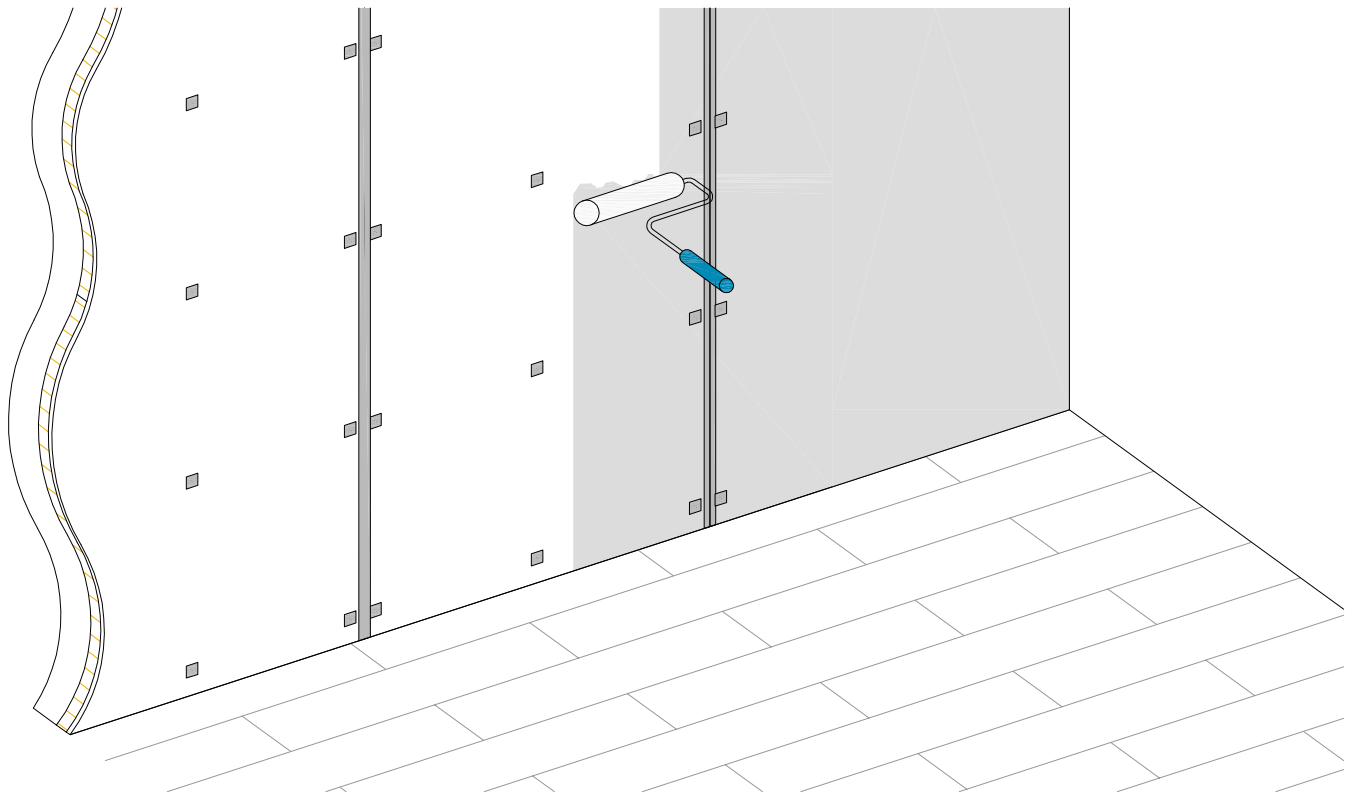

Una vez seco el rejuntado ya se puede aplicar el remate de acabado.

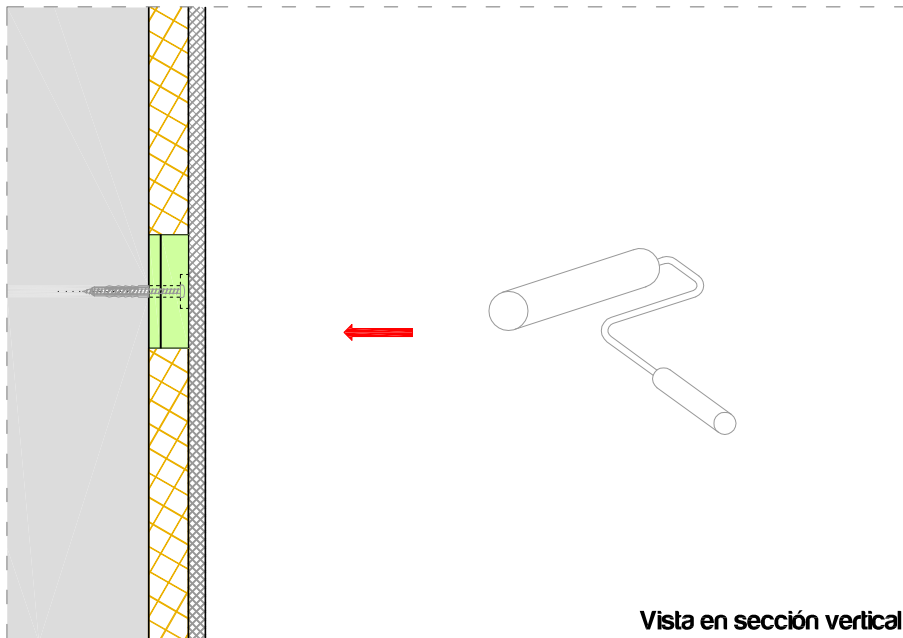

7

